

SITE PLAN OF A PIECE OF LAND OF SRI ARNAB BASU & OTHERS. AT MOUZA- DIGLA. J. L. NO.-18. IN R.E. SU NO.-161. TOUZI NO.-173. R.S DAG NO.-7. R.S. KHATIAN NO-2034(HAL) & 364(OLD). ~~IN RESPECT OF MUNICIPAL HOLDING NO.-137. KABI MUKUNDA DAS ROAD. WARD NO.-02. UNDER SOUTH DUM DUM MUNICIPALITY. P.S.-DUM DUM. DISTRICT- 24 PARGANAS (N). L.R. DAG NO.-7~~

SITE PLAN FOR PROPOSED AS PER RULE STORIED BUILDING

NATURE OF LAND -

AREA STATEMENT
 TOTAL AREA OF LAND-11 KH. 07 CH. 15 SFT.----- 766.44 Sqm. (AS PER DEED)
 TOTAL AREA OF LAND-11 KH. 15 CH. 26 SFT.----- 800.91 Sqm. (AS PER MEASURED) (EXTRA LAND= 34.47Sqm.)
 TOTAL AREA OF LAND-11 KH. 07 CH. 15 SFT.----- 766.44 Sqm.
 PERMISSIBLE COVERED AREA(50%)-----383.22 Sqm.

CERTIFICATE OF OWNERS

I ALSO UNDERTAKE TO REPORT THAT THERE IS NO COURT CASE OR ANY COMPLAIN FROM MY ANY CORNER OF MY PROPERTY AS PER SITE
 I ALSO UNDERTAKE THAT I HAVE NOT SOLD /TRANSFER ANY PORTION OF MY PROPERTY. TO ANY BODY UPTIL NOW SOUTH DUM DUM MUNICIPALITY WILL NOT BE LIABLE IF ANY TYPE OF DISPUTE ARISES
 CERTIFIED THAT THE TIME OF CONSTRUCTION OF MY BUILDING I REPAIR OR CONSTRUCTED THE PORTION OF EXISTING DRAIN & ROAD IN FRONT OF MY PREMISES OF ANY DAMAGE OCCURS

Arnab Basu
Gayatri Basu
Arnab Basu

SIG. OF OWNER

Ranadhir Saha
RANADHIR SAHA
 Licenced Building Surveyor
 SDDM
 Class : II
 LIC No. - SDDM/26/2023-2024

SIG. OF L.B.S.

DRAWN BY: SWEET HOME/ SCALE:- 1:200 & N.T.S

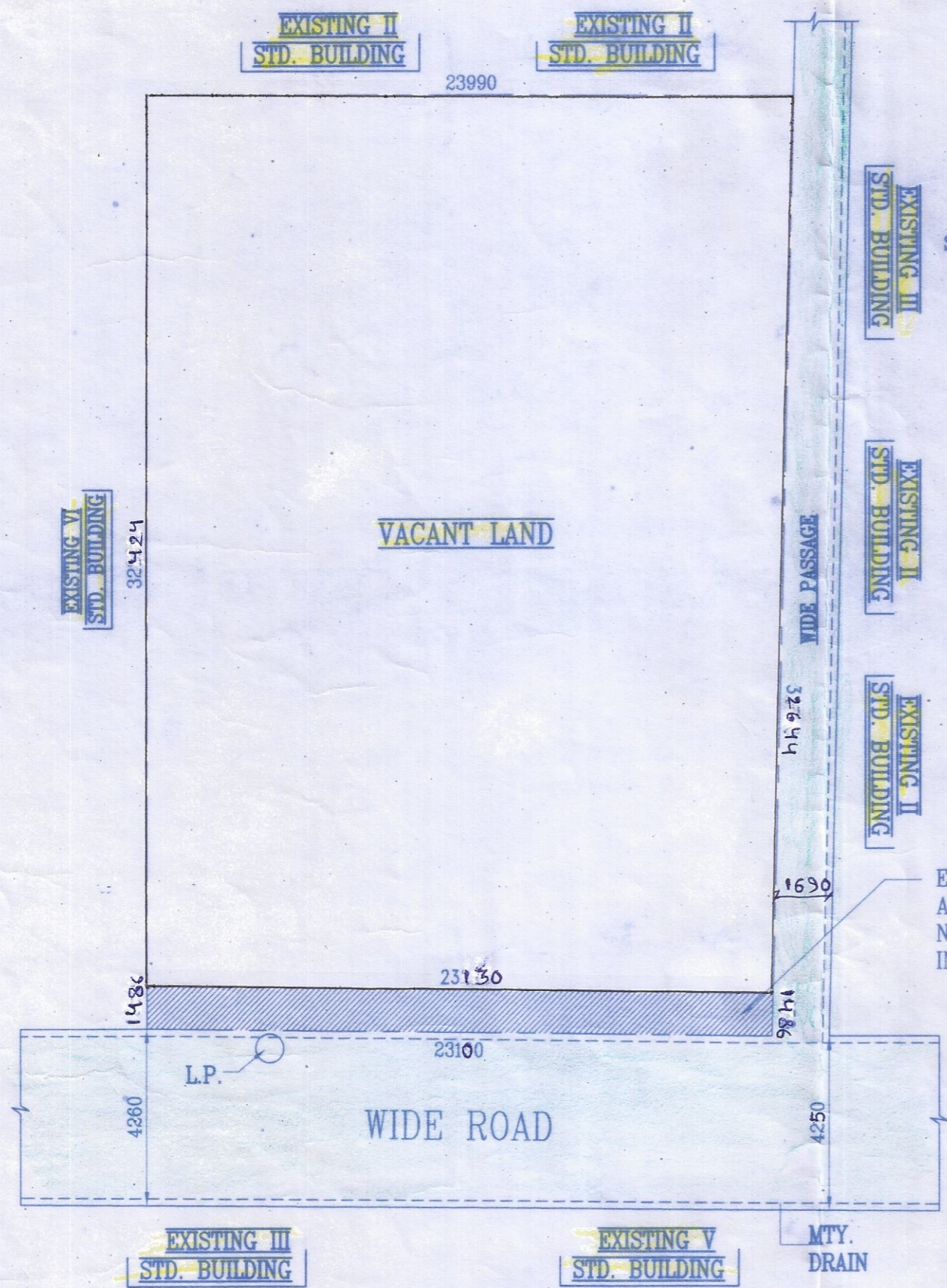

SITE PLAN
 SCALE = 1:200

Sandeep
 Sub Assistant Engineer
 South Dum Dum Municipality

1247



The site plan is approved subject to the conditions that the conditions that the Municipality shall not be held responsible in case any dispute arises out of the use or ownership of the site and no construction work shall be started without obtaining prior sanction of the Building Plan.

APPROVED

K.C
30/12/24

Chairperson
South Dum Municipality

[Handwritten signature]
30/12/24

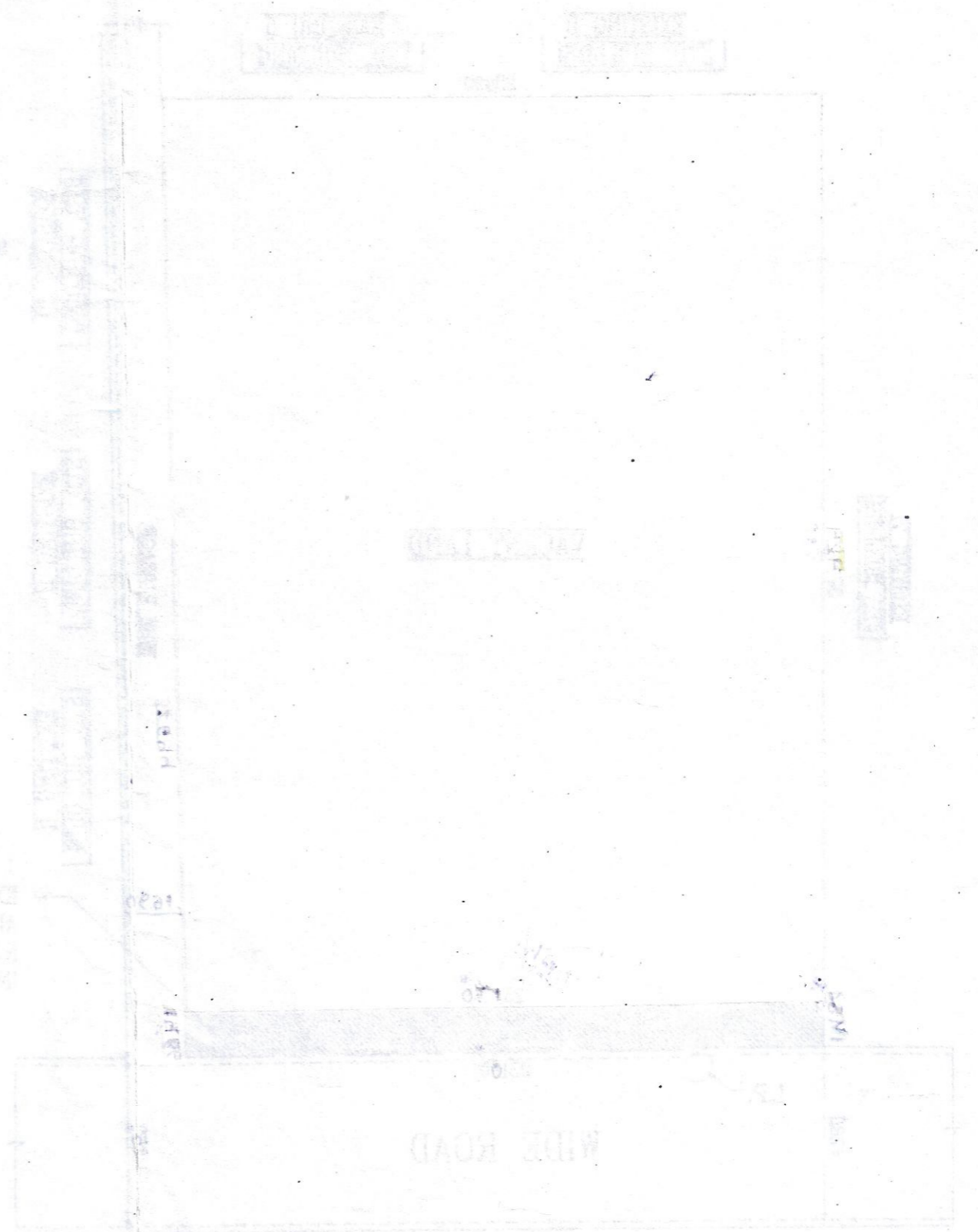

SITE PLAN

[Handwritten signature]
RANADHIR SAHA
Licenced Building Surveyor
Class II
LIC No - SDDM12581503-3024

SIG. OF L.B.S.

[Handwritten signature]
Licenced Building Engineer
South Dum Municipality

[Faint, mostly illegible text in the left margin, possibly containing application details or dates.]